

# User Guide

For video tutorials visit the support page at [www.swiftpoint.net](http://www.swiftpoint.net)

## Swiftpoint™ Mouse



USB receiver/charger

## 4 Recharging

When the mouse battery is low, the battery LED will flash every 5 seconds.

- The first 30 seconds of charging will give you up to one hour of use. During this RapidCharge™ the battery LED will flash rapidly.
- To fully charge the mouse, leave it docked until the battery LED glows steadily. This takes up to 90 minutes and gives 2-4 weeks of normal use.

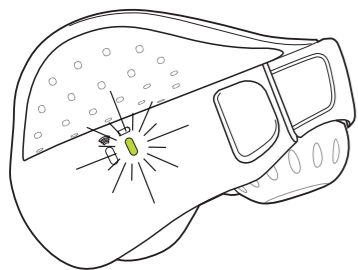

Fully charging the mouse periodically will prolong battery life.

## 1 Dock and Charge

- Plug the USB receiver into a USB port.
- To charge the mouse, dock it on to the USB receiver.

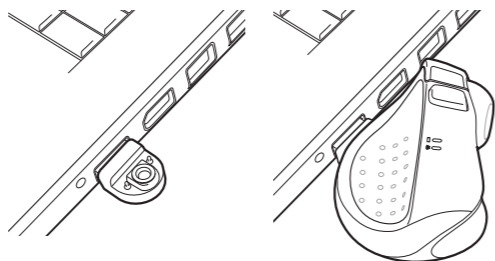

### Before first use perform a full charge.

The Battery LED will flash while charging and will glow steadily when charging is complete. This may take up to 90 minutes.



The first time you plug the USB receiver into a Mac, a window may pop up saying "keyboard cannot be identified...". This message can be safely ignored. Click the red close button in the upper-left corner of the window to "cancel".

## 2 Hold the Mouse

Hold the mouse as shown, with your thumb in the thumb grip and your middle finger on the finger grip. Rest your index finger on the grip surface of the left-click button.



Do not place your thumb too far forward

## 3 Scrolling, Zooming and Paging

Use your index finger to roll the scroll wheel.

You can scroll rapidly by lifting the mouse and rolling the scroll wheel along the mousing surface. This is called SlideScroll™ and is useful when you want to scroll quickly through documents.

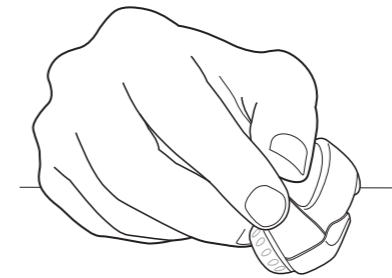

While SlideScrolling:

- Hold down the left-click button to zoom in and out.
- Hold down the right-click button to page up and down.

## 5 Set the 'Up' Direction

You may find that you hold the mouse at different angles when using your laptop in different environments. This may mean that the pointer doesn't move in the direction that you expect.

To ensure that you are comfortable in any location, you can easily change the angle that your mouse regards as 'up'. To do this:



- Hold the mouse at a comfortable angle.
- Press and hold down both mouse buttons.
- After 2 seconds the mouse pointer will position itself at the bottom of the screen and move up (as illustrated).
- Release the buttons and move the mouse pointer in a straight line upward until the pointer moves in a small circle.

The new up direction has now been set.

## 6 SmartTouch™

The SmartTouch™ sensor ensures the mouse pointer stops moving when your finger is not detected on the finger grip.

When you type, it is best to move the mouse to a position between your hands, but doing this

will also move the pointer across your screen. When SmartTouch™ is on, you can move your mouse without any pointer movement by lifting your middle finger and then moving the mouse with your thumb.

SmartTouch™ will be set to off by default. To activate it:

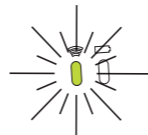
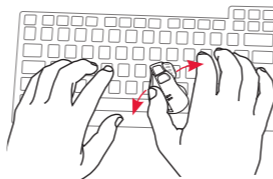

- Press and hold down both mouse buttons.
- After 2 seconds, the status LED will glow.
- Release the buttons and when the status LED turns off, roll the scroll wheel.

The status LED will flash once indicating SmartTouch™ is now on.

You can switch SmartTouch™ off again by repeating the steps above.

## 7 Using the Parking Accessory (optional)

The parking accessory allows you to use your laptop on an angle. When the mouse is positioned on the parking space, it will magnetically attach to the film and not slide off.



The parking space also helps position your mouse between your hands, so that you can type without any obstruction.

Refer to the instructions on the parking accessory on how to apply.



If you have a laptop with a highly reflective palmrest, the parking accessory will allow the mouse to work more efficiently.

## Is the Pointer on the screen moving too fast or too slow?

You can adjust the pointer speed in your computer settings. To find out how to do this, and for other tips on using the mouse, see our support page at [www.swiftpoint.net](http://www.swiftpoint.net).

## Need Help?

For help on using your product or technical queries please visit the support page at [www.swiftpoint.net](http://www.swiftpoint.net) or email us at [support@swiftpoint.net](mailto:support@swiftpoint.net).

### Systems Requirements

Hardware: 1 x USB port

Operating Systems: Either Windows® 7 / Windows Vista® / Windows® XP / Windows® 2000 / Mac OS® 10.4 or higher

### Ergonomic Information

Repetitive use of computers and computer peripherals such as mice and keyboards over prolonged periods may result in physical discomfort and/or injury to muscles, tendons and nerves. Such outcomes may also be due to an incorrect body posture, an ergonomic work set-up, or poor work habits. If you experience any pain, swelling, stiffness, numbness or other discomfort of these in your hands, wrists, arms, neck, shoulders, back or other parts of your body while using a computer, you should immediately contact a qualified medical professional.

### Regulatory Information

#### FCC Declaration

This device complies with part 15 of the FCC Rules. Operation is subject to the following two conditions:

- This device may not cause harmful interference, and
- This device must accept any interference received, including interference that may cause undesired operation.

Changes or modifications not expressly approved by Swiftpoint Limited could void the user's authority to operate the equipment.

#### Industries Canada Statement

This device complies with the requirements of RSS 210 of Industry Canada.

(Cet appareil est conforme à la RSS 210 d'Industrie Canada.)

#### CE Declaration of Conformity

Swiftpoint Limited hereby declares that this device complies with the essential requirements and other relevant provisions of EU Directive 1999/5/EC and related standards.

The technical documentation as required by the Conformity assessment procedure is kept at the following address:

Unit 5, 27 Tyne Street,  
Christchurch, New Zealand  
Internet: [www.swiftpoint.net](http://www.swiftpoint.net)

#### Product Disposal

Please dispose of this product and packaging in a responsible manner and in accordance with any applicable local or national disposal regulations, including those governing the recovery and recycling of waste electrical and electronic equipment (WEEE).

#### Patent Information

Patents pending in the United States and other countries.

This warranty does not affect your statutory rights.

Features and specifications of the product and this user guide are subject to change without notice.

Microsoft, Windows 7, Windows Vista and Windows XP are either registered trademarks or trademarks of Microsoft Corporation in the United States and/or other countries. Mac OS is either a registered trademark or trademark of Apple Corporation in the United States and/or other countries. All trademarks and registered trademarks are the property of their respective owners.

User guide version v2010.1 © 2010 Swiftpoint Limited. All rights reserved.